

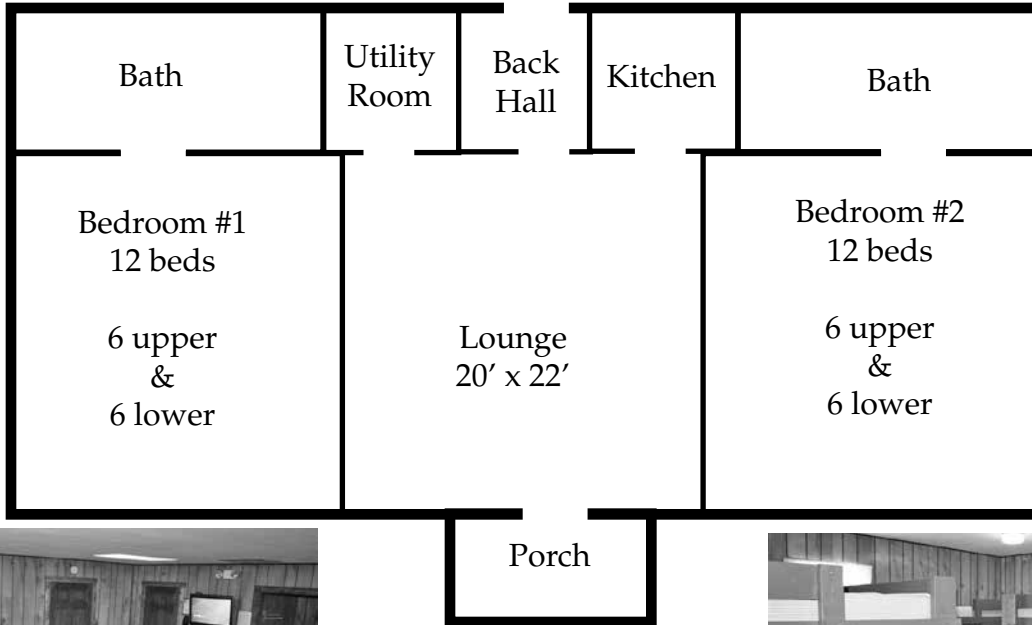

Pine Cabin

Floor Plan & Room Assignment Sheet

Total Capacity
24 persons
12 upper beds & 12 lower beds



Room #1 - 6 upper & 6 lower

1. _____
2. _____
3. _____
4. _____
5. _____
6. _____
7. -----
8. -----
9. -----
10. -----
11. -----
12. -----



Room #2 - 6 upper & 6 lower

1. _____
2. _____
3. _____
4. _____
5. _____
6. _____
7. -----
8. -----
9. -----
10. -----
11. -----
12. -----

Room Assignment Legend

a solid line indicates
a lower bed
a dotted line indicates
an upper bunk